

# Front VIEW

# Back VIEW

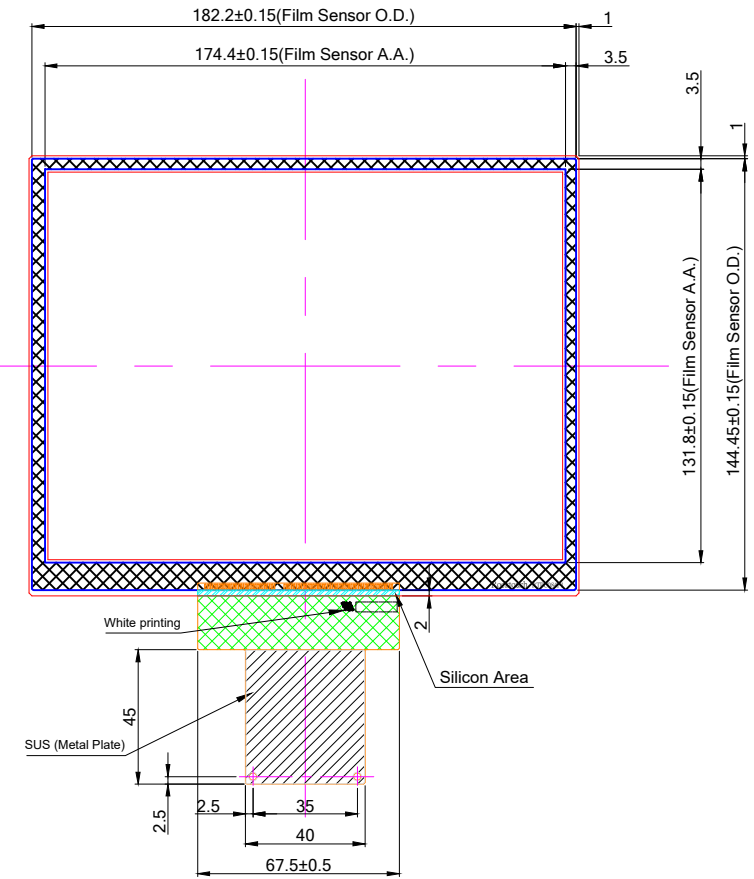
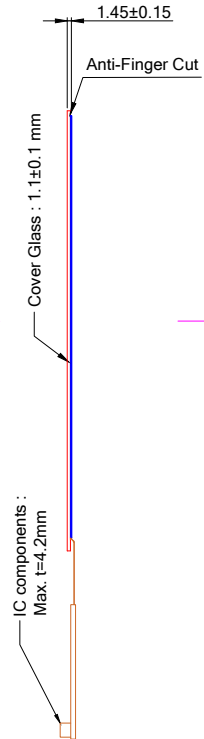
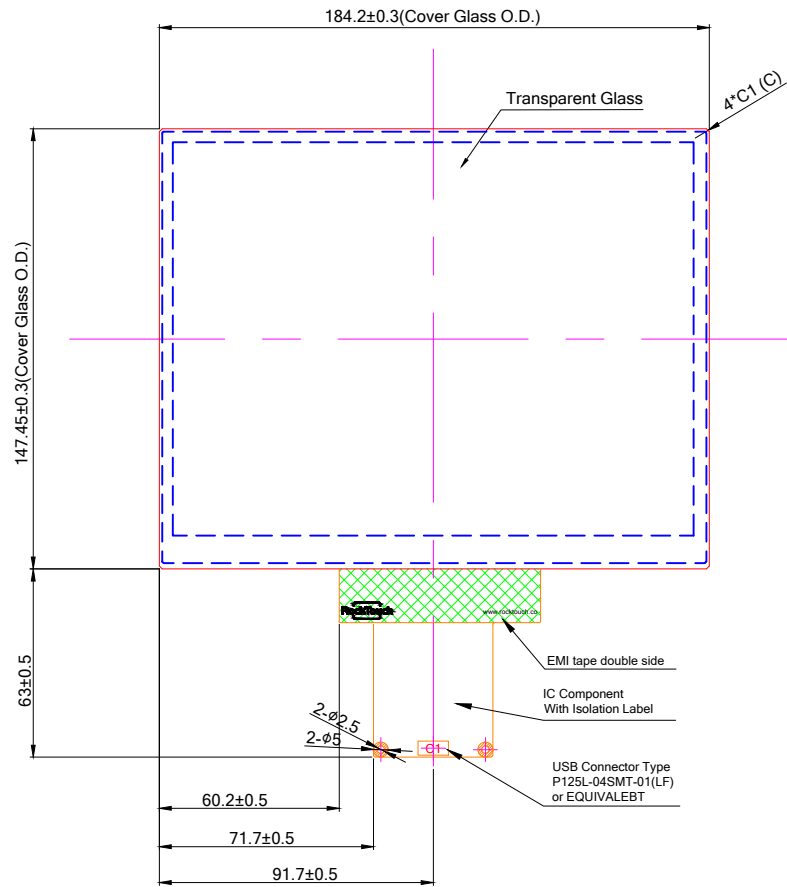

C1: Pin Define for USB 4 pin

Pin 01	GND
Pin 02	D-
Pin 03	D+
Pin 04	VDD

- Spec:
- 1. General O.D. Tolerance :  ±0.3
  - 2. Border Type :  Matte
  - 3. Glass Type :  C.S.
  - 4. Surface Treatment :  None
  - 5. Background Printing :  None
  - 6. Logo Printing :  None
  - 7. Transmittance Level : >85%
  - 8. Important Notes :

- Note:
- A. Distance between LCD and Touch must be at least 1 mm otherwise touch will not work correctly
  - B. If customer put a front cover lens all around he need to use at least 2 mm Thick gasket between touch and metal frame
  - C. refer to the integration guide to avoid any integration noise issue
  - D. before mass production customer must provide machine for final firmware tuning, or we must test in remote and tune final firmware

Date	↑
Drawing Number	

Customer Approval		Part Number		RTPC084F1-R11TG1-U	
Date	Rev. Date	Person	Description		
Company					
Name					
Signature	Date	Design By Date	Check By Date	Approved By	
	20200511	Jeff			

